



Project: _____
 Location: _____
 Cat. #: _____
 Type: _____
 Quantity: _____

LED

ETL G2 24 | LED Lensed Troffer

Features:

- High performance LED technology
- 90+ CRI standard
- 0-10V dimming drivers standard
- Field replaceable LED boards and drivers
- Multiple shielding options optimized to balance efficiency and aesthetics
- Available in multiple lumen output packages for maximum flexibility

Applications:

Suitable for most commercial and institutional applications

- Office
- Retail
- Classrooms
- Healthcare Facilities

Schematic:

Cross Section

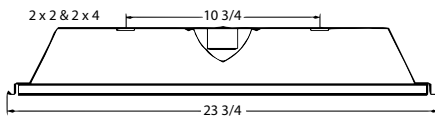

Side View

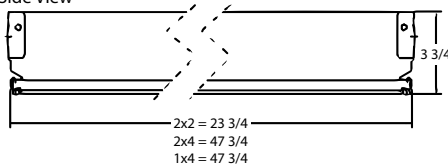

Construction:

- Die-formed heavy-gauge cold rolled steel
- LED tray is precision brake formed from aluminum
- White enamel finish

Certifications:

- UL 1598 listed for US and Canada, suitable for damp locations



Predicted Lifetime:

- L70 ≥ 131,000 hrs (calculated)
 - L90 ≥ 40,000 hrs (reported)
- (based on LM-80, TM-21 and in-situ laboratory testing)

Warranty:

- 5 year limited system warranty
- See www.LumenFocus.com for complete warranty terms and conditions
- 10 year warranty option available on specific models
(Not available on all models. Certain conditions apply. Consult factory or sales representative for details.)



Ordering Guide:

example: ETL G2 24 LW UV A12 940 W6

Series	Size	Output	Voltage	Shielding	CRI/CCT	Controls	Options
ETL G2	24						
ETL G2 ETL Gen2	24 2' x 4'	SL Super Low	UV 120-277	A12 Pattern 12 Prismatic Acrylic Lens	930 90 CRI/3000K	Blank No Controls	Blank No Options
		VL Very Low	34 347V	PW Pattern 12 Prismatic Acrylic Lens	935 90 CRI/3500K	ZOSMD 0-10V Dimming Microwave Occupancy Sensor ⁽¹⁾	EXT10 10-Year Extended Warranty ⁽¹⁾
		LW Low		A23F Frosted High Efficiency Pattern 23 Acrylic Lens	940 90 CRI/4000K	ZIFC Douglas IFC Controller with Newtork Capabilities ⁽¹⁾	W6 6' Whip
		ML Medium Low			950 90 CRI/5000K		EM Emergency Pack ⁽²⁾
		MD Medium					F Fuse
		HI High					GC Grid Clip
		VH Very High					RLY Relay
		SH Super High					SC Safety Cable
							LVL 0-10V Dimming Leads for Easy Field Access
							BAA Buy American Act Compliant

Notes

⁽¹⁾ See page 3 for more details.

⁽²⁾ Not available on all models. Certain conditions apply.
Consult factory or sales representative for details.

⁽³⁾ Up to 12W (120-277V / 0°C-50°C ambient)

Performance Chart:

Catalog #	Watts	Lumens (930)	LPW (930)	Lumens (935)	LPW (935)	Lumens (940)	LPW (940)	Lumens (950)	LPW (950)
ETL G2 24 SL UV A12 9xx	22.9	3012.6	131.3	3025.3	131.8	3097.1	135.0	3097.1	135.0
ETL G2 24 VL UV A12 9xx	28.5	3782.1	132.5	3798.0	133.0	3888.2	136.2	3888.2	136.2
ETL G2 24 LW UV A12 9xx	31.9	4250.9	133.2	4268.8	133.8	4370.2	137.0	4370.2	137.0
ETL G2 24 ML UV A12 9xx	37.7	4944.1	131.0	4964.9	131.6	5082.9	134.7	5082.9	134.7
ETL G2 24 MD UV A12 9xx	45.3	5897.8	130.2	5922.6	130.7	6063.3	133.8	6063.3	133.8
ETL G2 24 HI UV A12 9xx	54.3	6910.5	127.2	6939.7	127.8	7104.5	130.8	7104.5	130.8
ETL G2 24 VH UV A12 9xx	58.6	7884.0	134.4	7917.2	135.0	8105.3	138.2	8105.3	138.2
ETL G2 24 SH UV A12 9xx	66.1	8866.3	134.1	8903.7	134.7	9115.2	137.9	9115.2	137.9



The ETL G2 features field replaceable boards and drivers. This allows you to upgrade to more efficient technology in the future. Or, in the rare event of a failure, you can rapidly replace defective components. Re-boardABILITY helps to ensure you won't get stuck with an obsolete light fixture. [Learn more about Re-boardABILITY here.](#)



Controls Summary:

Control Code	Type	Capabilities	Communication
ZOSMD	Motion (Microwave), Photosensor	On/Low/Off	Wired 1-10V
ZIFC	Controller, No Sensors	High/Low/Off, High-End Trim, Grouping, LLLC (Douglas Lighting Controls-Dialog)*	Wireless Bluetooth Mesh, Programmable via iOS App or Douglas Dialog Software

LLLC = Luminaire Level Lighting Control

* Additional equipment required. Contact LumenFocus representative for details

Universal Douglas: Cloud-based controls

Intelligent Fixture Controller (IFC)

The ETL G2 can be equipped with the Douglas Bluetooth Intelligent Fixture Controller (IFC).

- 0-10V dimming with dim-to-off
- Bluetooth beacon for digital ceiling, IoT and location service strategies
- 150-foot clear line of sight, 50 feet through standard walls
- May be used with dual-channel, tunable white LED drivers providing auxiliary power and dim-to-off capability
- Commissioning through Douglas Lighting Controls, Inc. app from Apple app store
- Listed for emergency control when used on dedicated emergency power bus



CheckLight® Energy Management System

Douglas controls can be integrated with the CheckLight® Energy Management system. This system can help you uncover energy conservation opportunities, create conservation strategies, analyze lighting load inefficiencies, and make configuration changes from anywhere with Douglas' user-friendly interface. You can get measurements, reports, and control your system from a web-based application.

CheckLight® has the capability to look at different facilities within a portfolio and use data benchmarks to compare building performances.

- Find energy conservation opportunities
- Create energy saving strategies
- Analyze load inefficiencies
- Optimize energy management

ZOSMD option: Leviton 0-10V High Frequency Microwave Sensor

The ETL G2 can be equipped with an integrated Leviton 0-10V dimming high frequency microwave sensor ("ZOSMD" option). The ZOSMD detects motion through low density materials allowing it to be installed out of site, under the lens. The high frequency waves offer less interference and false tripping than traditional sensing technology for reliable occupancy applications. The integrated daylighting sensor detects natural light and turns lights ON or keeps lights OFF in response to available natural light or the daylight set point when motion is detected.



- Automatic switching or dimming based on motion
- Ambient light override
- Designed to detect movement behind low-density fixture materials or behind objects made of plastic or glass
- Up to 40' mounting height
- Detection Zone: 52' diameter x 49' Height Max
- Standby Dimming Level: 10% / 20% / 30% / 50%
- IP20 rated
- 120-277V

Photometric Data:

Relative Luminous Intensity

